

Product group – Latch clamps

Application areas

Quick closing of covers and flaps on rotating or stationary containers, drums, boxes and moulds. The latch clamp is distinguished by its compact design together with high holding force. The latch hooks can be adjusted on all models.

The essential product features

- **New:** convenient, patented one-hand operation by means of thumb control lever
- Compact design
- High holding forces



Model 331 during the locking of a container



Holding force max. [N]	Length [mm]	Height [mm]	Model no.	Category	Page
900	140	44	330	Standard hook	6.6
1.600	82	52	324	Standard vertical	6.12
1.600	96	28,5	323	Standard horizontal	6.2
1.700	215	50	301	Standard eyelet	6.11
1.700	216	58	351-B	Standard horizontal	6.10
2.200	216	55,5	351	Standard hook	6.6
2.200	241,5	55,5	351-R	Release lever	6.7
3.200	151	56,5	331	Standard horizontal	6.2
3.200	104	61,5	334	Standard vertical	6.12
3.200	201	56,5	331-50	Standard horizontal	6.2
3.200	155	52	331-R	Standard horizontal	6.3
3.200	202,5	52	331-R-50	Standard horizontal	6.3
3.400	305,5	75,5	371	Standard hook	6.6
3.400	326	75,5	371-R	Release lever	6.7
4.500	346,5	88,5	381	Standard hook	6.6
7.000	203	71,5	341	Standard horizontal	6.2
7.000	137	82	344	Standard vertical	6.12
7.000	303	71,5	341-100	Standard horizontal	6.2
7.000	253	71,5	341-50	Standard horizontal	6.2
7.000	204,5	72,5	341-R	Standard horizontal	6.3
7.000	254,5	72,5	341-R-50	Standard horizontal	6.3
15.000	260	107	375	Standard horizontal	6.4
15.000	260,5	105,5	375-B	Standard horizontal	6.9
15.000	258,5	105,5	375-BR	Release lever	6.10
15.000	260	107	375-R	Release lever	6.5
27.000	244	95,5	385	Standard horizontal	6.4
27.000	244,5	95,5	385-R	Release lever	6.5

■ With latch hook

Application areas

Quick closing of covers and flaps on rotating or stationary containers, drums, boxes and moulds. The models with release lever listed below are preferred where vibration of containers, transportation of boxes and drums is required.

Safety instructions

Refers to models 331-R and 341-R.

In order to guarantee a secure form of locking, the clamp must be moved into the corresponding end position.

Product features

- New: with patented lever
- Rivets made of stainless steel
- Galvanised and passivated
- Oil-resistant, ergonomically shaped DE-STA-CO plastic handle

Accessories

- Latch clamps of this series are delivered complete with latch hook and latch plate
- **Note:** Models 331 and 341 possess additional latch hook lengths. See dimension L1

Models 323, 331, 331-50, 341, 341-50, 341-100

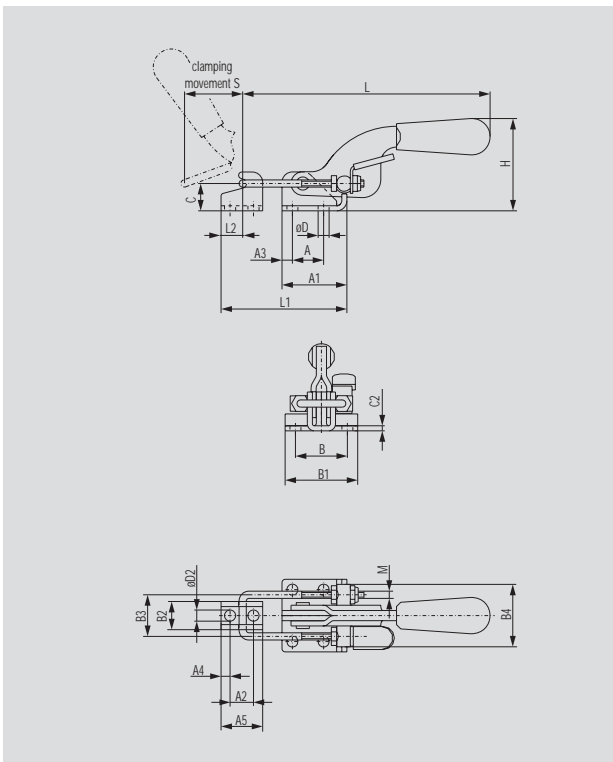



Model no.	◀ [N]	⚖️ [kg]	Adjustment range [mm]
323	1.600	0,07	0-12
331	3.200	0,25	0-20
331-50	3.200	0,3	0-20
341	7.000	0,75	0-22
341-50	7.000	0,8	0-22
341-100	7.000	0,85	0-22

Versions in stainless steel on page 8.10



Model no.	A	A1	A2	A3	A4	A5	B	B1	B2	B3	B4	C	C2	øD	øD2	H	L	L1max.	L2	M	S
323	16	26	10	5	4	20	19	28	13	19	28	12	2	4,2	4,2	28,5	96	59	9	M4	27,5
331	19	39,5	14,3	6,5	5,5	25,3	32	44,5	17	25,5	38	16,5	3	6,7	6,7	56,5	151	80	12,3	M5	35,5
331-50	19	39,5	14,3	6,5	5,5	25,3	32	44,5	17	25,5	38	16,5	3	6,7	6,7	56,5	201	130	12,3	M5	35,5
341	41,3	60,5	19	9,6	9,5	38	38	54	30	44,5	60,5	23,8	4	8,5	8,5	71,5	203	118	19	M8	66,5
341-50	41,3	60,5	19	9,6	9,5	38	38	54	30	44,5	60,5	23,8	4	8,5	8,5	71,5	253	168	19	M8	66,5
341-100	41,3	60,5	19	9,6	9,5	38	38	54	30	44,5	60,5	23,8	4	8,5	8,5	71,5	303	218	19	M8	66,5

Models 331-R, 331-R-50, 341-R, 341-R-50

Model no.	 [N]	 [kg]	Adjustment range [mm]
331-R	3.200	0,3	0-12
331-R-50	3.200	0,31	0-12
341-R	7.000	0,71	0-22
331-R-50	7.000	0,73	0-22

Versions in stainless steel on page 8.11

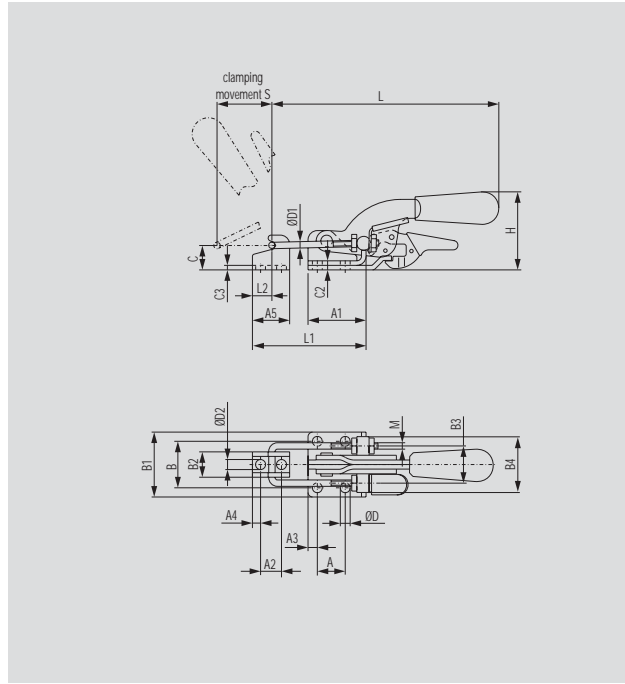

Model no.	A	A1	A2	A3	A4	A5	B	B1	B2	B3	B4	C	C2	C3						
331-R	19	39,5	14,3	6,5	5,5	25,5	31,8	44,5	17	25,5	38	16,5	6	3						
331-R-50	19	39,5	14,3	6,5	5,5	25,5	31,8	44,5	17	25,5	38	16,5	6	3						
341-R	41,3	60,5	19	9,5	9,5	38	38	54	30	44,5	60,5	24	4	4						
341-R-50	41,3	60,5	19	9,5	9,5	38	38	54	30	44,5	60,5	24	4	4						

Model no.	øD	øD1	øD2	H	L	L2	M	S	L1 _{max.}											
331-R	6,5	4,8	7	52	152,5	13	M5	35,5	80											
331-R-50	6,5	4,8	7	52	202,5	13	M5	35,5	130											
341-R	8,5	8	8,5	72,5	204,5	19,5	M8	66,5	118											
341-R-50	8,5	8	8,5	72,5	254,5	19,5	M8	66,5	168											

■ With latch hook

Application areas

Quick closing of covers and flaps on rotating or stationary containers, drums, but also boxes and moulds. Locking forces of up to 27.000 N.

Product features

- **New:** with patented lever
- Base and latch plate cast, burnished
- Galvanised and passivated
- Partially oil-resistant, ergonomically shaped DE-STA-CO plastic handle

Accessories

- Latch clamps of this series are delivered complete with latch hooks and latch plates

Model 375

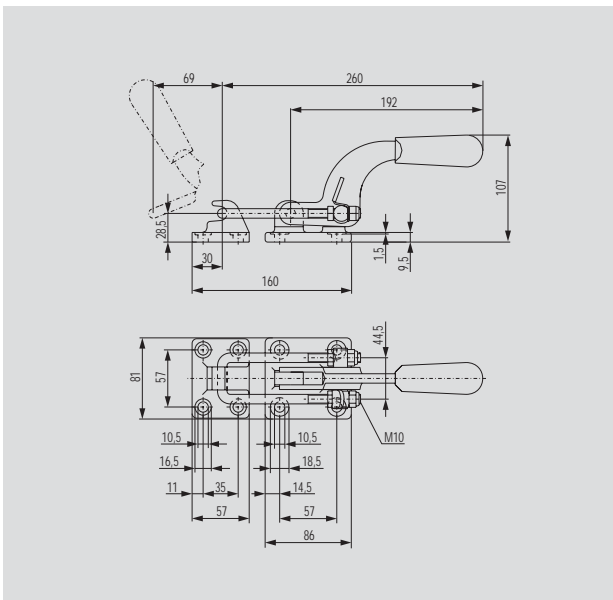

Model no.	◀ [N]	⚖️ [kg]	Adjustment range [mm]
375	15.000	1,7	0-16



Model 385

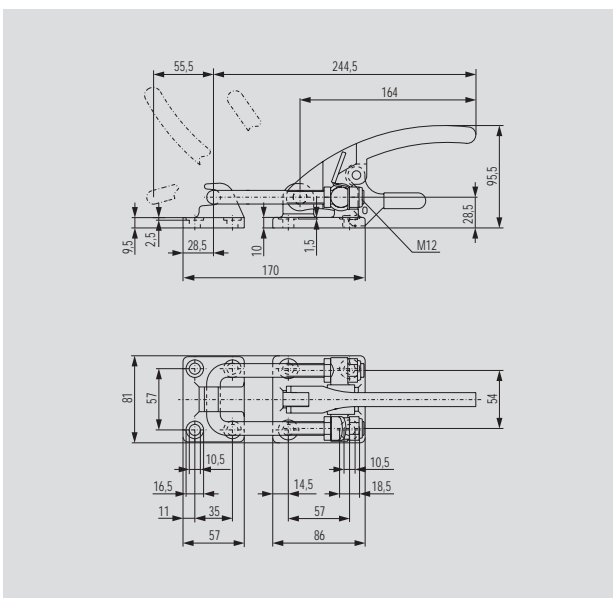

Model no.	◀ [N]	⚖️ [kg]	Adjustment range [mm]
385	27.000	1,9	0-26,5

Versions in stainless steel on page 8.11



Latch clamps – horizontal

- With latch hook

Application areas

Quick closing of covers and flaps on rotating or stationary containers, drums, boxes and moulds. Locking forces of up to 27.000 N.

The models with release lever listed below are preferred where vibration of containers, transportation of boxes and drums is required.

Safety instruction

In order to guarantee a secure form of locking, the clamp must be moved into the corresponding end position.

Product features

- New: with patented lever
- Base cast, burnished
- Galvanised and passivated
- Oil-resistant, ergonomically shaped DE-STA-CO plastic handle

Accessories

- Latch clamps of this series are delivered complete with latch hooks and latch plates

Model 375-R

Model no.	☛ [N]	⚖️ [kg]	Adjustment range [mm]
375-R	15.000	1,75	0-16

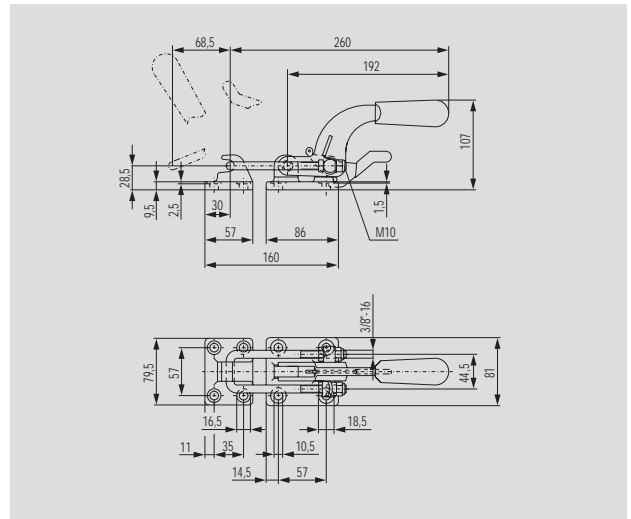

Model 385-R

Model no.	☛ [N]	⚖️ [kg]	Adjustment range [mm]
385-R	27.000	2	0-26.5

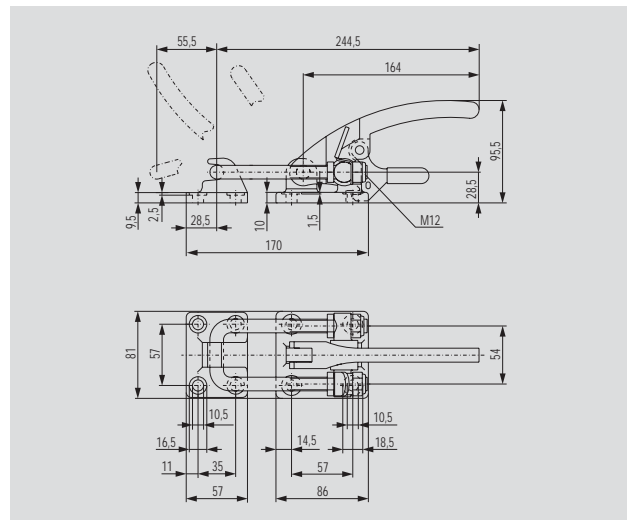

■ With hook

Application areas

Quick closing of covers and flaps on rotating or stationary containers, drums, boxes and moulds. Locking forces of up to 4.500 N.

The models with additional release lever listed below are preferred where vibration of containers, transportation of boxes and drums is required, also other lockable moulds.

Safety instruction

Refers to models 351-R and 371-R.

In order to guarantee a secure form of locking, the clamp must be moved into the corresponding end position.

Product features

- **New:** with patented lever
- Rivets made of stainless steel
- Galvanised and passivated
- Oil-resistant, ergonomically shaped DE-STA-CO plastic handle

Accessories

Latch clamps of this series are delivered without latch plates

Models 330, 351, 371, 381

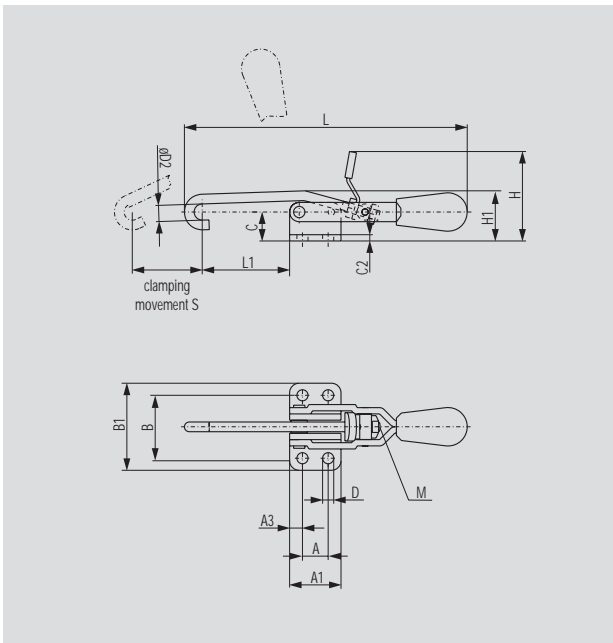

Model no.	◀ [N]	⚖️ [kg]	Adjustment range [mm]	Latch plate accessories
330	900	0,11	0-3	330000
351	2.200	0,28	0-9	351000
371	3.400	0,7	0-23	371000
381	4.500	1,13	0-19	381000

Versions in stainless steel on page 8.13



Model no.	A	A1	A3	B	B1	C	C2	øD	øD2	H	H1	L	L1	S	M					
330	12,7	25,5	6,5	31	43	14,5	3	5,5	8	44	25	140	43	34,5	5					
351	19	38	12,7	35	49,5	19	3	5,5	9,5	55,5	36	231	54,5	72	8					
371	32	49	8,5	49,5	67	36	4	8,5	12,5	75,5	57,5	305,5	75	105,5	10					
381	28,5	54	12,7	60	85,5	46	4,5	10,5	16	88,5	72	346,5	82,5	117,5	12					

Models 351-R, 371-R

Model no.	◀ [N]	⚖ [kg]	Adjustment range [mm]	Latch plate accessories
351-R	2.200	0,33	0-10	351000
371-R	3.400	0,8	0-23	371000

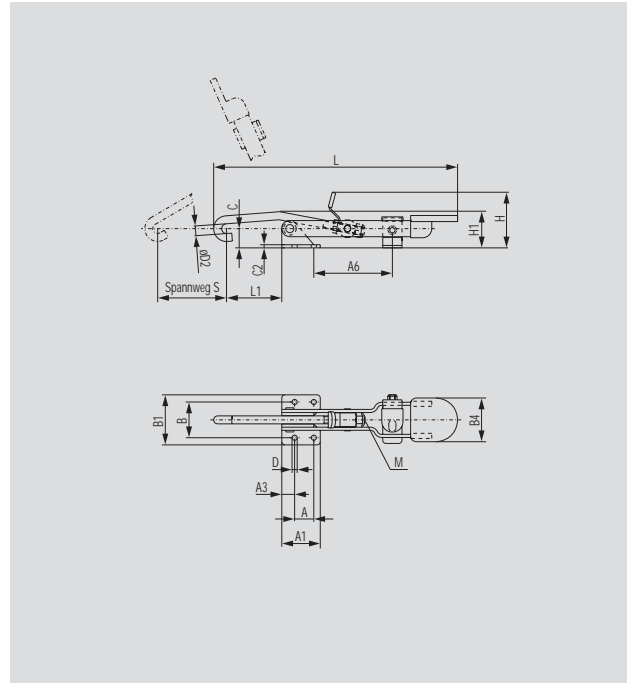

Model no.	A	A1	A3	A6	B	B1	B4	C	C2	øD	øD2	H	H1	L	L1	S	M				
351-R	19	38	12,7	78	35,5	49,5	43,5	19	3	5	9,5	55	36,5	241,5	54,5	68	8				
371-R	32	49	8,5	120	49	66,5	60	36	4	8,5	12,5	75,5	57,5	326	75	139	10				

Latch clamps 351-R and 371-R

Information concerning the assembly and function of the clamps locking mechanism

The locking link which is supplied with the unit must be fastened with a screw (M6) as shown in this illustration. The screw head should be flat.

Function

When closing the latch clamp, the locking lever engages automatically. Actuate the locking lever to open the clamp.

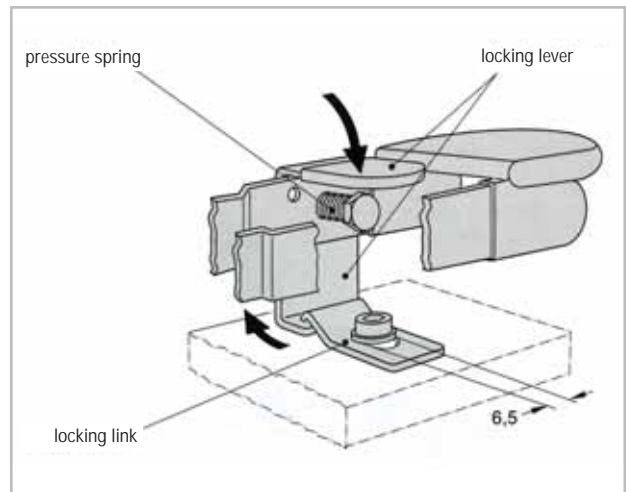

NEW

Latch plates for models 330, 351, 371, 381

Information

DE-STA-CO has developed J-hook latch plates to help reduce engineering time when installing DE-STA-CO J-hook style clamps. The J-hook latch plate guarantees that the latch point is below the centre line of the clamp assembly's two pivot points. This allows for the proper toggle lock action.

Models 330000, 351000, 371000, 381000

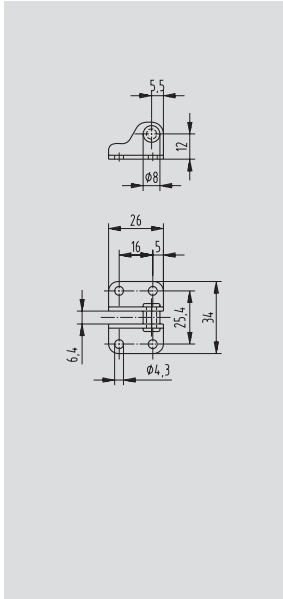

Model 330000

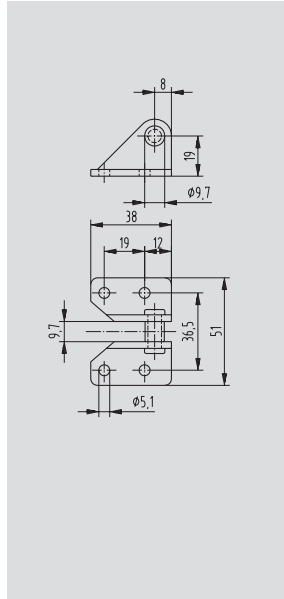

Model 351000

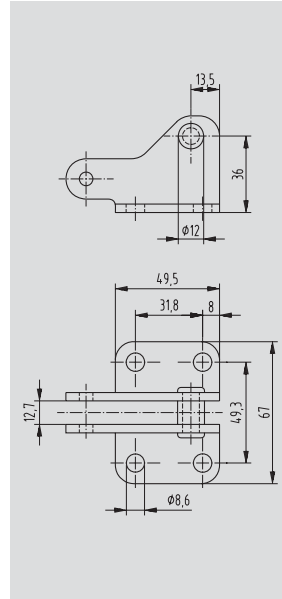

Model 371000

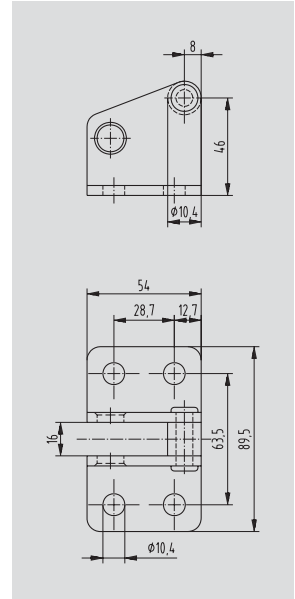

Model 381000



Model no.	 [kg]
330000	0,018
351000	0,064
371000	0,2
381000	0,3

Latch clamps – horizontal

- With latch hook or hook
- Base to be weld on

Application areas

Quick closing of covers and flaps on rotating or stationary containers, drums, but also boxes and moulds. Locking forces of up to 15.000 N.

The models with release lever listed below are preferred where vibration of containers, transportation of boxes and drums is required.

Safety instruction

Refers to model 375-BR.

In order to guarantee a secure form of locking, the clamp must be moved into the corresponding end position.

Product features

- **New:** with patented lever
- Base cast
- Galvanised and passivated
- Oil-resistant, ergonomically shaped DE-STA-CO plastic handle

Accessories

- Locking clamps of this series are delivered complete with latch hooks and latch plates or with hooks and without latch plates

Model 375-B

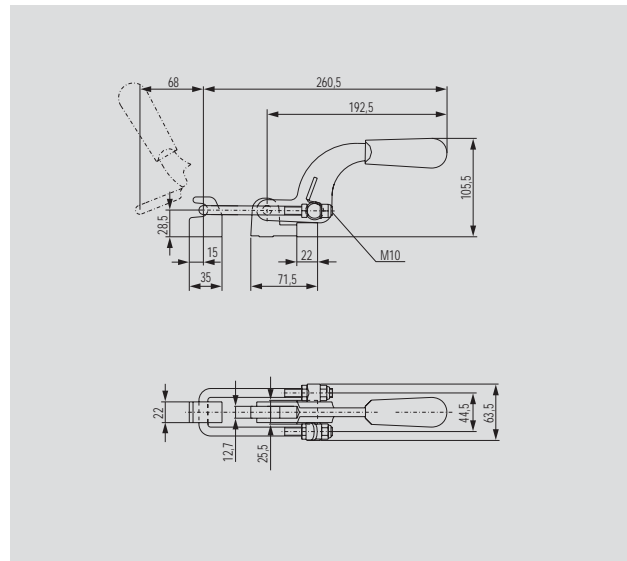

Model no.	◀ [N]	⚖️ [kg]	Adjustment range [mm]
375-B	15.000	1,1	0-19

Base and latch plate: Mat. C22

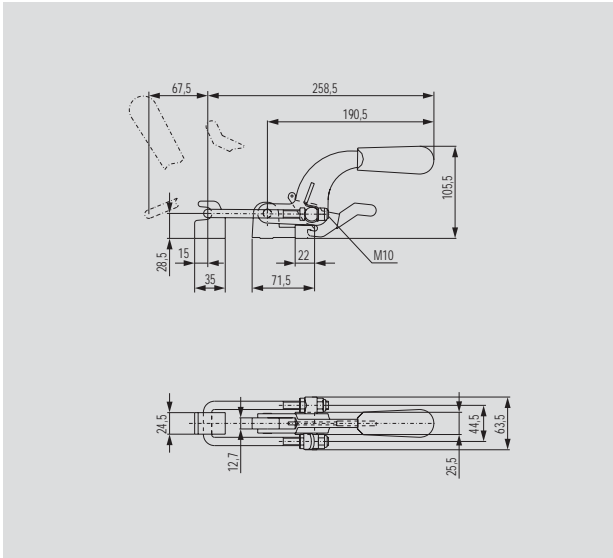

Model 375-BR





Model no.	 [N]	 [kg]	Adjustment range [mm]
375-BR	15.000	1,1	0-19

Base and latch plate: Mat. C22

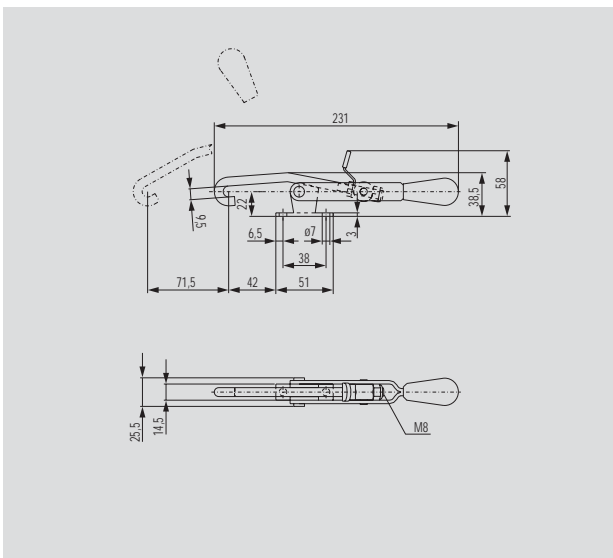

Model 351-B



Model no.	 [N]	 [kg]	Adjustment range [mm]
351-B	1.700	0,3	0-9

Versions in stainless steel on page 8.13



Model 301

Model no.	 [N]	 [kg]	
301	1.700	0,37	

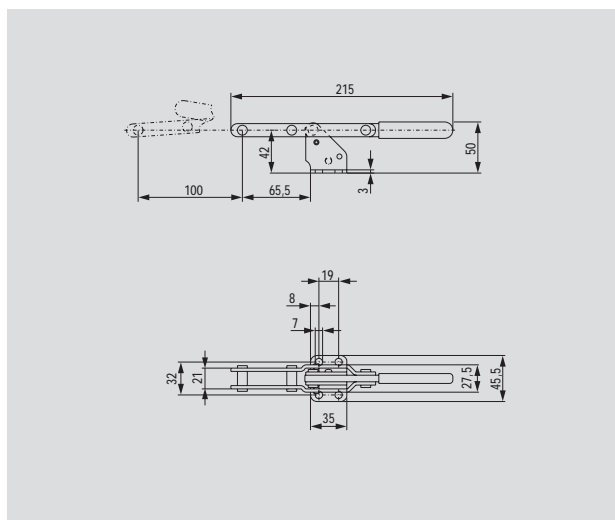

■ With latch hook

Application areas

Quick clamping at an angle, locking of covers and flaps on rotating or stationary containers, drums, but also boxes and moulds. Locking forces of up to 7.000 N.

Product features

- New: with patented lever
- Rivets made of stainless steel
- Galvanised and passivated
- Oil-resistant, ergonomically shaped DE-STA-CO plastic handle

Accessories

- Latch clamps in vertical design are delivered complete with latch hooks and latch plates

Models 324, 334, 344

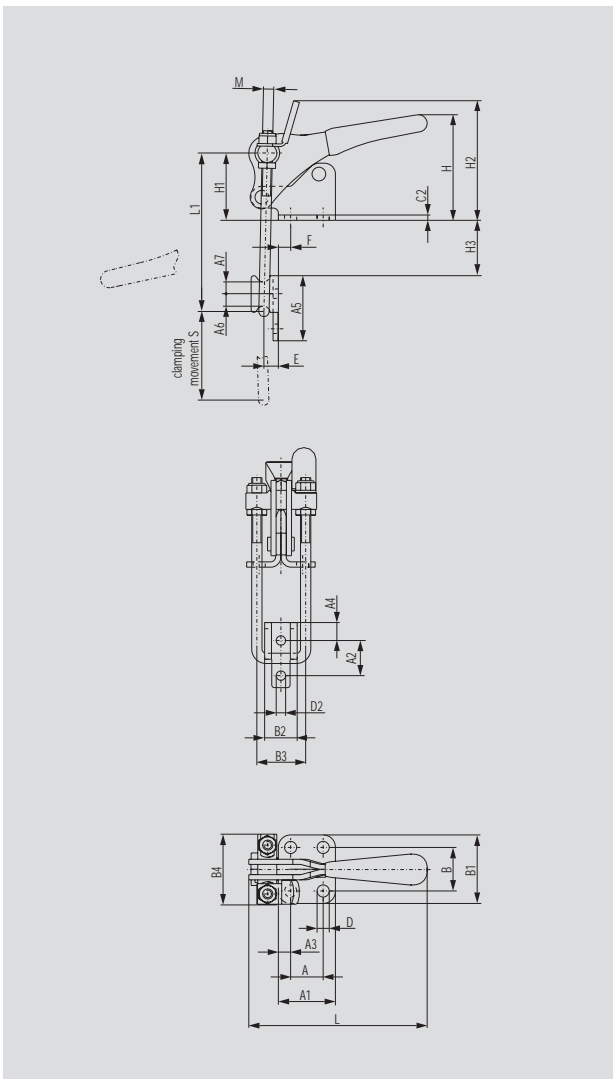

Model no.	[N]	[kg]	Adjustment range [mm]
324	1.600	0,1	0-8
334	3.200	0,25	0-15
344	7.000	0,75	0-21

Versions in stainless steel on page 8.12



Model no.	A	A1	A2	A3	A4	A5	A6	A7	B
324	12,7	25,5	14,3	6,5	7	25,5	4,8	4,8	22
334	19	33,5	20,5	7	10,5	38	7,5	7	25,5
344	32	49	27	8,5	17,5	54	9	10	36,5

Model no.	B1	B2	B3	B4	C2	øD	øD1	øD2	H	H2	L	L1 _{max.}	M	S	E	F	H3 _{max.}	H1
324	35	13,5	20,5	30	2	5	4	4,5	52	52	82	64	M4	38,5	4,7	6,4	21,9	28,1
334	40	19	28,5	41,5	3	7	6	5,5	61,5	70	104	92,5	M6	51,5	8,8	7,1	32,2	39,3
344	54	30	44,5	61	4	8,5	8	8,5	82	80	137	126	M8	63	12,7	7,9	48,8	46,6