

Product range

C-Style

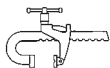

Holding force max. [N]	Model no.	Page
5.650	T321-10	11.3
9.000	T285-9	11.3
9.000	T285-18	11.3
9.000	T285-40	11.3
11.300	T186-6	11.3
11.300	T186-12	11.3
11.300	T186-20	11.3
11.300	T186-30	11.3
18.000	T290-9	11.3
18.000	T290-18	11.3
18.000	T290-40	11.3
27.000	T257-12	11.3
27.000	T257-24	11.3
27.000	T257-54	11.3

Bar Style

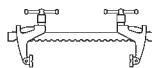

Holding force max. [N]	Model no.	Page
5.650	T321-24	11.5
5.650	T321-36	11.5
5.650	T321-60	11.5
9.000	T285-36	11.5
9.000	T285-60	11.5
9.000	T285-84	11.5
11.300	T186-24	11.5
11.300	T186-36	11.5
18.000	T290-36	11.5
18.000	T290-60	11.5
18.000	T290-84	11.5
27.000	T257-84	11.5

*For license reasons no sales of Carver Clamps through DE-STA-CO in the U.K.

T-Slot Style

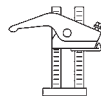

Holding force max. [N]	Model no.	Page
16.000	T600-4	11.7
16.000	T600-8	11.7
22.700	T400-4	11.7
22.700	T400-8	11.7
25.000	T602-6	11.7
25.000	T602-12	11.7
25.000	T602-18	11.7
36.300	T402-6	11.7
36.300	T402-12	11.7
36.300	T402-18	11.7
36.300	T402-24	11.7

Edge Grip Style



Holding force max. [N]	Model no.	Page
22.500	T500	11.9
45.000	T550	11.9

Buttress style



Holding force max. [N]	Model no.	Page
13.000	T614-0	11.11
62.500	T614-1	11.11
80.000	T614-2	11.11

*For license reasons no sales of Carver Clamps through DE-STA-CO in the U.K.

C-Style



Holding force [N]	Throat Depth B ₁	Width Opening S	Model no.	Weight [kg]	
 11.300 N	60	150	T186-6	1,4	
		300	T186-12	1,8	
		500	T186-20	2,5	
		750	T186-30	3,2	
 5.650 N	120	250	T321-10	2	
 18.000 N	90	225	T290-9	5,5	
		450	T290-18	7	
		1000	T290-40	10,5	
 9.000 N	200	225	T285-9	7,1	
		450	T285-18	8,5	
		1000	T285-40	11,5	
 27.000 N	115	300	T257-12	10,9	
		600	T257-24	13,1	
		1350	T257-54	19,1	

*For license reasons no sales of Carver Clamps through DE-STA-CO in the U.K.

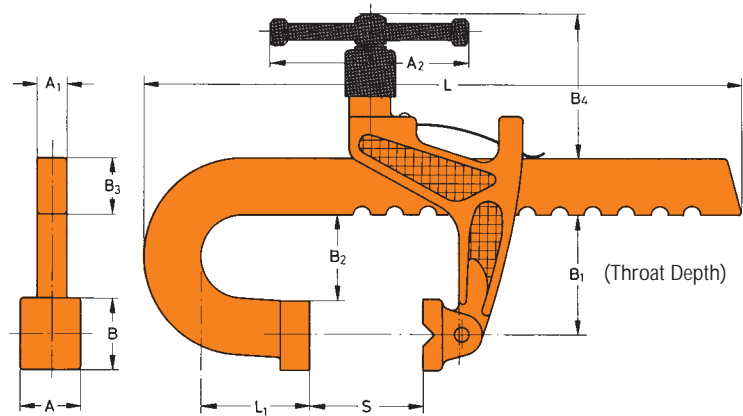

Model no.	A	A ₁	A ₂	B	B ₂	B ₃	B ₄	L	L ₁
T186-6	25	13	76	32	43	33	76	245	20
T186-12	25	13	76	32	43	33	76	395	20
T186-20	25	12	76	35	43	30	76	695	80
T186-30	25	12	76	35	43	30	76	875	30
T321-10	25	13	76	32	102	33,5	76	360	25
T290-9	40	20	140	60	65	40	105	420	65
T290-18	40	20	140	60	65	40	105	655	65
T290-40	40	20	140	60	65	40	105	1205	65
T285-9	40	20	140	60	180	40	105	420	65
T285-18	40	20	140	60	180	40	105	655	65
T285-40	40	20	140	60	180	40	105	1205	65
T257-12	51	22	187	60	85	51	127	555	100
T257-24	51	22	187	60	85	51	127	850	100
T257-54	51	22	187	60	85	51	127	1615	100

*For license reasons no sales of Carver Clamps through DE-STA-CO in the U.K.

Bar-Style



Connector

Fits 2 bars

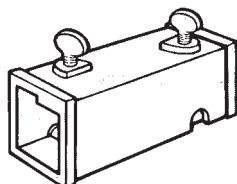

Model no.	For Bar Clamps Model no.	Weight [kg]
186-13	T186-... and T321-..	0,7
285/290-13	T285-... and T290-..	1,3

Holding force [N]	Throat Depth B ₁	Width Opening S		Width Opening S ₁		Model no.	Weight [kg]
		min.	max.	min.	max.		
 11.300 N	60	70	600	75	680	T186-24	3,4
		70	900	75	990	T186-36	4,4
 5.650 N	120	10	600	80	690	T321-24	3,5
		10	900	80	1000	T321-36	4,5
		10	1500	80	1600	T321-60	5,9
 18.000 N	90	100	900	120	1005	T290-36	10,5
		100	1500	120	1620	T290-60	14
		100	2100	120	2220	T290-84	18
 9.000 N	200	30	900	100	1085	T285-36	11,5
		30	1500	100	1700	T285-60	15
		30	2100	100	2300	T285-84	19
 27.000 N	115	150	2100	150	2200	T257-84	27,2

*For license reasons no sales of Carver Clamps through DE-STA-CO in the U.K.

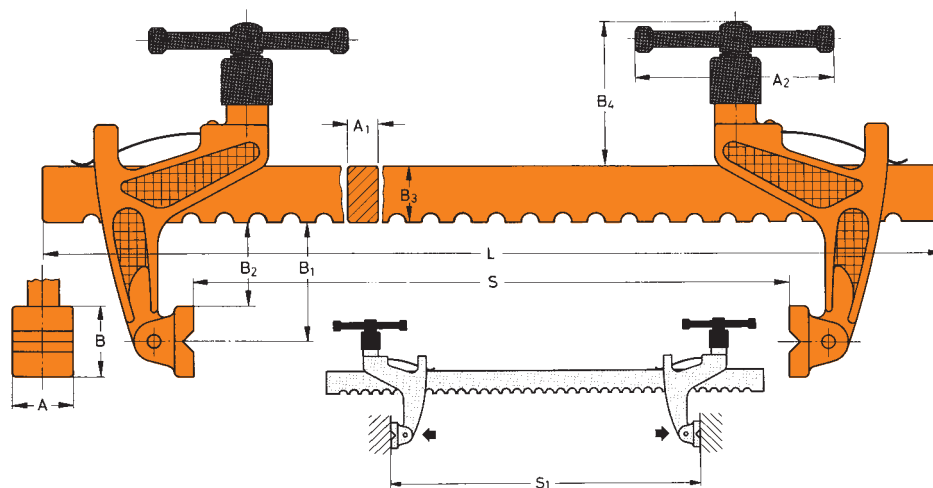

Model no.	A	A ₁	A ₂	B	B ₂	B ₃	B ₄	L
T186-24	25	12	76	32	44	30	76	710
T186-36	25	12	76	32	44	30	76	1020
T321-24	25	12	76	32	104	30	76	710
T321-36	25	12	76	32	104	30	76	1020
T321-60	25	12	76	32	104	30	76	1625
T290-36	38	20	140	51	65	40	105	1070
T290-60	38	20	140	51	65	40	105	1690
T290-84	38	20	140	51	65	40	105	2290
T285-36	38	20	140	51	180	40	105	1070
T285-60	38	20	140	51	180	40	105	1690
T285-84	38	20	140	51	180	40	105	2290
T257-84	51	22	187	63,5	83	52	127	2335

*For license reasons no sales of Carver Clamps through DE-STA-CO in the U.K.

T-Slot Style

These patented clamps provide rapid height adjustment and positive holding. They are designed with a single-unit clamp head and base. The DE-STA-CO Carver T-Slot Clamp is one single assembly – there are no loose parts.



When setting up, the safety lock on the back is released and the clamp lifted on the base to the desired height. When the clamp screw is turned, 100% of the force is transmitted to the work-piece. Backing off the clamp adjusting screw and releasing the safety lock and lifting the clamp head makes for rapid job changeover.

If the clamping height is more than 750 mm the connector shown below will be delivered as standard equipment.

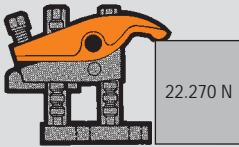
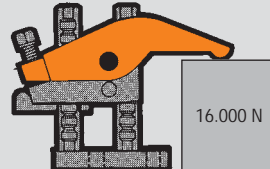
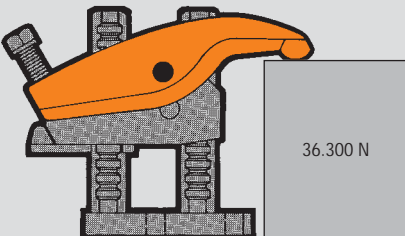
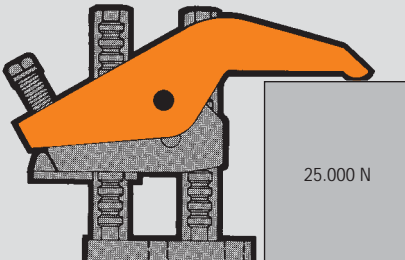

Bestell-Nr. **T81340**

Holding force [N]	Throat Depth		Working Height C		Model no.	Accessories standard equipment	Weight [kg]
	a	b	min.	max.			
 22.270 N	14	33	25 62	100 200	T400-4 T400-8	2 T-slots nuts T2060-05 matching T-slot 14 mm	2 2,3
 16.000 N	57	73	12 50	100 200	T600-4 T600-8		2,4 2,7
 36.300 N	44	68	0 150 300	150 300 450 600	T402-6 T402-12 T402-18 T402-24	2 T-slots nuts T2060-07 matching T-slots 18 mm	6,3 8 8,8 10,0
 25.000 N			0 150	150 300 450	T602-6 T602-12 T602-18		7,3 9,0 9,8

*For license reasons no sales of Carver Clamps through DE-STA-CO in the U.K.

Model no. T400-..

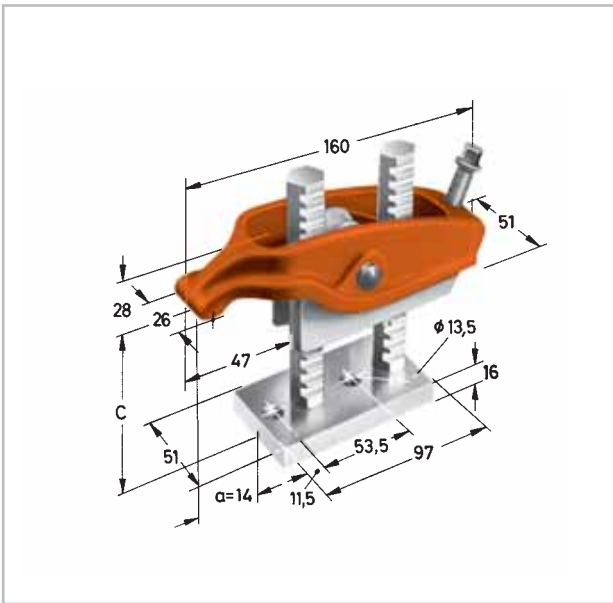

Model no. T402-..

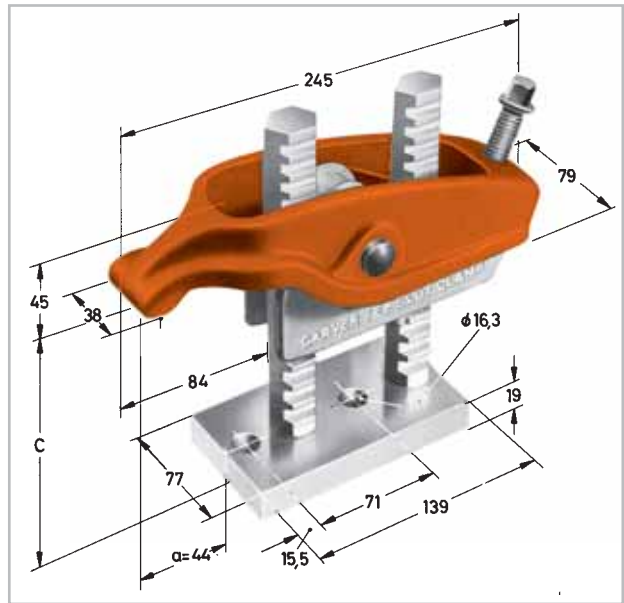

Model no. T600-..

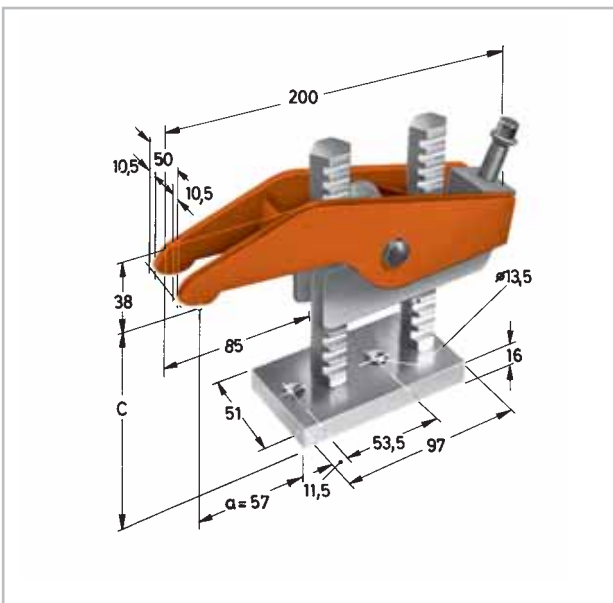

Model no. T602-..

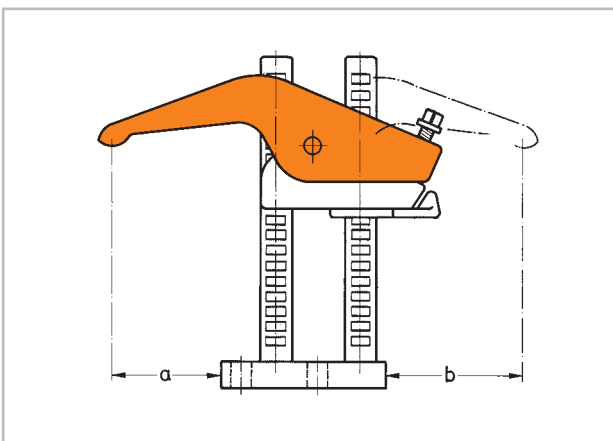
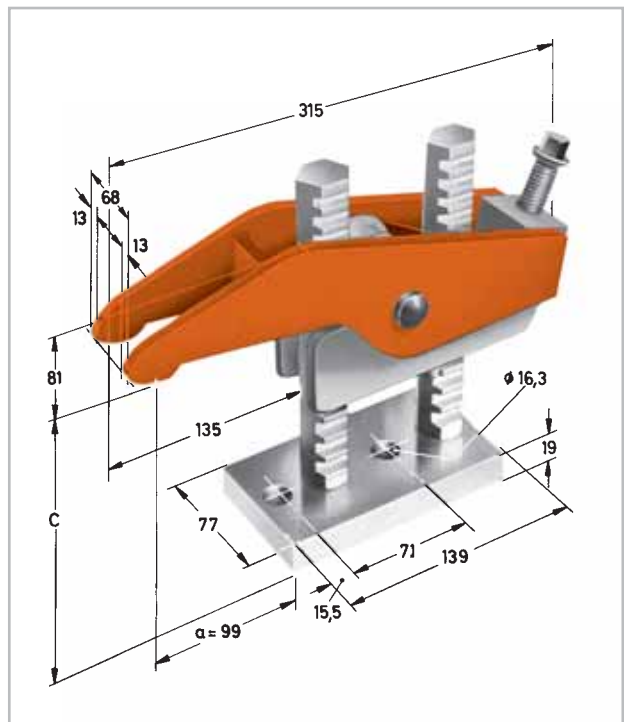

If the T402 and T602 will be reversed on their bases the measurement of the throat depth will change

	T400-..	T402-..	T600-..	T602-..
a	14	44	57	99
b	33	68	73	123

*For license reasons no sales of Carver Clamps through DE-STA-CO in the U.K.

Edge Grip Style

These low-profile clamps apply both horizontal and vertical clamping force against the workpiece to pull it down onto the work table as well as clamp it in position. They are designed to be used with T-Slot tables (or bolted to a plate) and allow maximum cutter access to the workpieces surface. Edge Grip Clamps are excellent for milling, planing, grinding and general surfacing operations which are beyond the capabilities of machine vises.

Because the Edge Grip Clamp set consists of two separate pieces – both locked to the T-Slot table – any length part (within the dimensions of the table) can be clamped.

The heavy-duty model also gives the additional advantage of swiveling through a full 360° for infinite angular alignment and gives a choice of two mounting hole sizes.

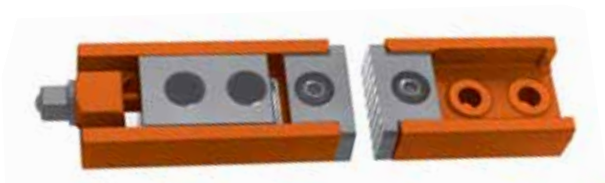

Model no. T500



Model no. T550

Clamping force		The total set consists	For screw diameter	Model no.	Weight [kg]
horizontal	vertical				
22.500 N	9.000 N	1 moving head with swarf cover 1 fixed head with swarf cover 4 T-slot nuts 14 (M12) 4 button head socket screws (M 12 x 35) 2 hex keys	13.5	T 500	3.8
45.000 N	18.000 N	1 Moving head 1 Fixed head	16.2 and 20.2	T 550	24

*For license reasons no sales of Carver Clamps through DE-STA-CO in the U.K.

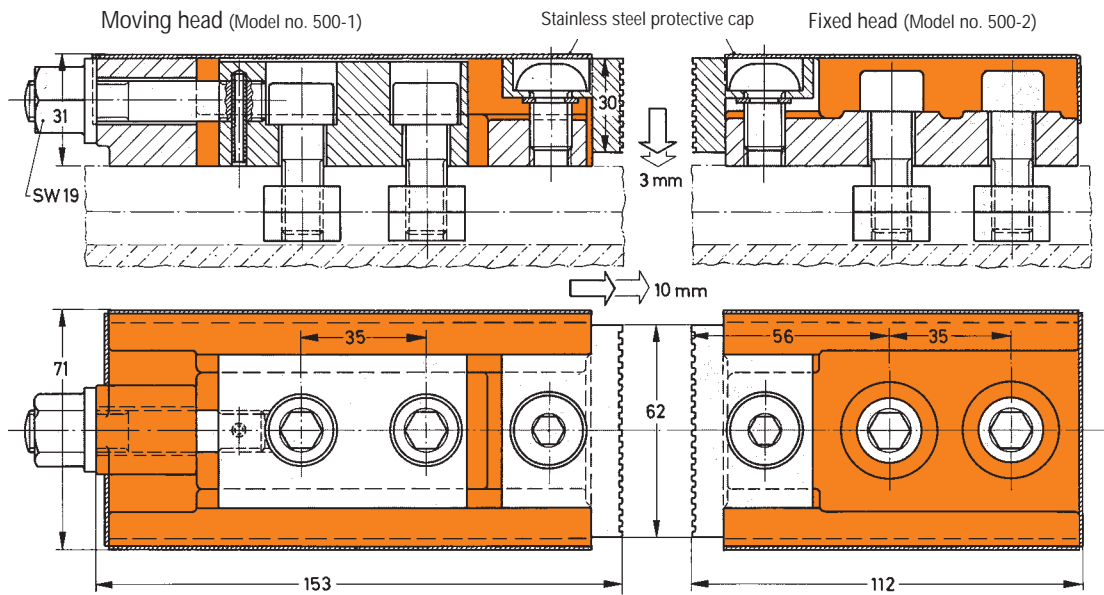

Operating instruction

1. Place clamps against workpiece and tighten cap screws on fixed head
2. Tighten anchor cap screws on moving head
3. Apply pressure with rear-nut slightly
4. Tighten down jaw screws on fixed and moving heads
5. Apply pressure with rear-nut

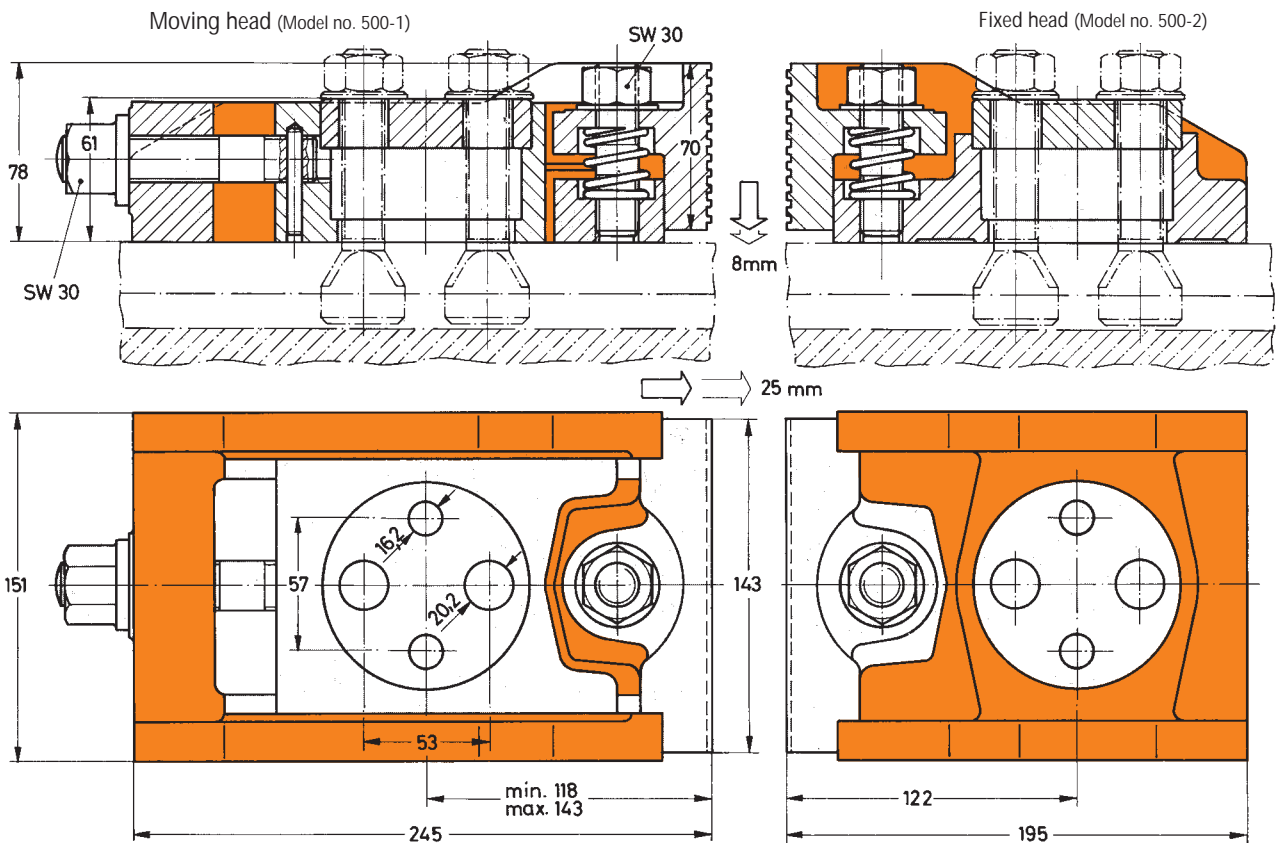
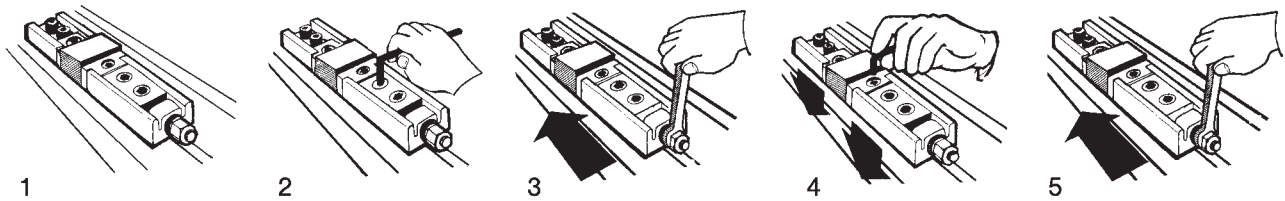

*For license reasons no sales of Carver Clamps through DE-STA-CO in the U.K.

Buttress Style

These workholding clamps are designed for use on thin or low-profile workpieces replacing ordinary strap clamps. They feature a self-aligning swiveling pivot which allows the tightening bolt to always remain vertical, preventing any side forces.

The two-point contact offered by Models T614-0 and T614-1 also provides greater stability to the workpiece. Ideally suited for manual die clamping. Eliminates the need for step blocks or riser blocks.



Holding force [N]	Working Height max.	For screw diameter	Model no.	Weight [kg]
 13.000 N	45	13	T614-0	0,6
 62.500 N	57	17 and 21	T614-1	2,7
 80.000 N	75	26	T614-2	4,3

*For license reasons no sales of Carver Clamps through DE-STA-CO in the U.K.

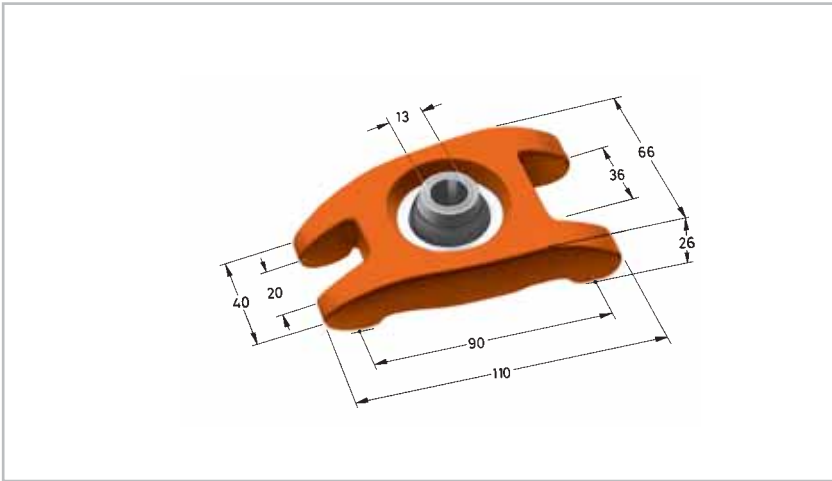

Holding force 13.000 N
Clamping height 45 mm max.
Model no. T614-0

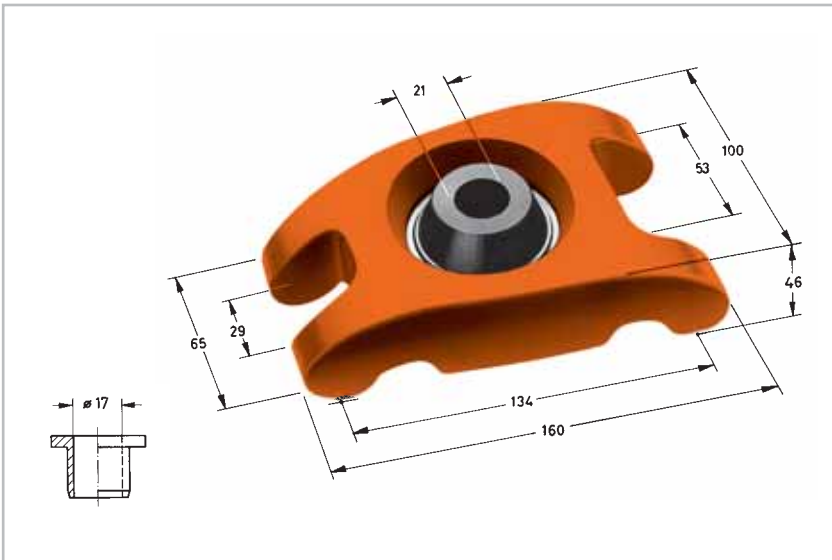

Holding force 62.500 N
Clamping height 57 mm max.
Model no. T614-1

Delivery includes reducing bush with inner diameter 17 mm.

Reducing bush is standard equipment

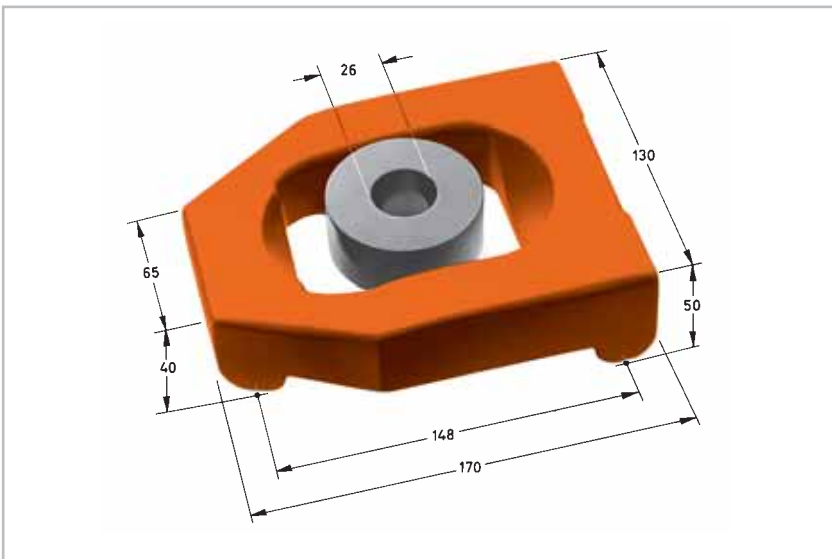

Holding force 80.000 N
Clamping height 75mm max.
Model no. T614-2

*For license reasons no sales of Carver Clamps through DE-STA-CO in the U.K.